

- NOTES:
- 1. MADE WITH CONCRETE 40 MPa
 - 2. AS PER MAIN ROADS SD1393
 - 3. FOR CROSSFALLS GREATER THAN 1:2

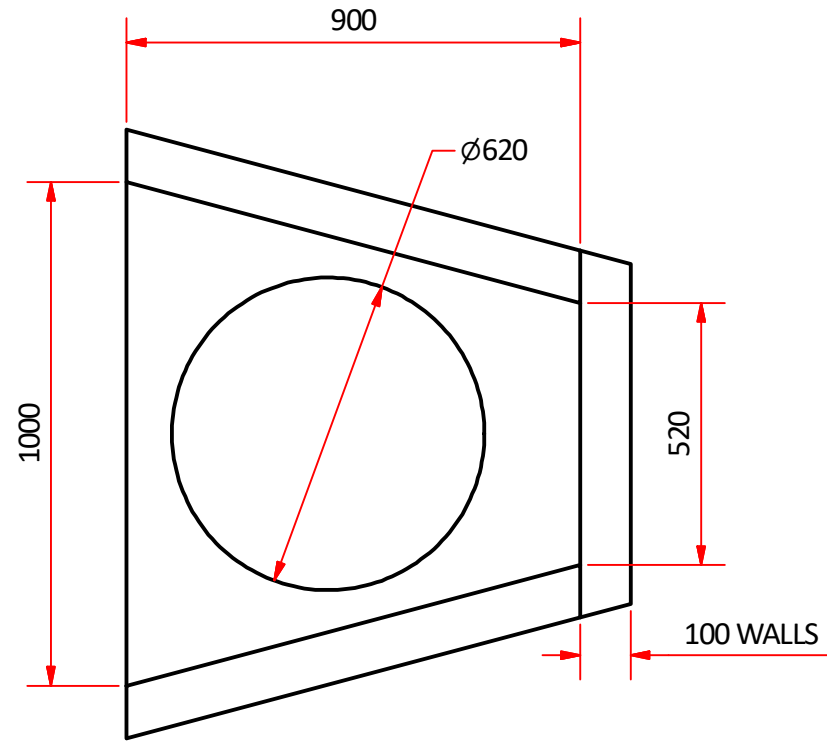

TOP VIEW (1:15)

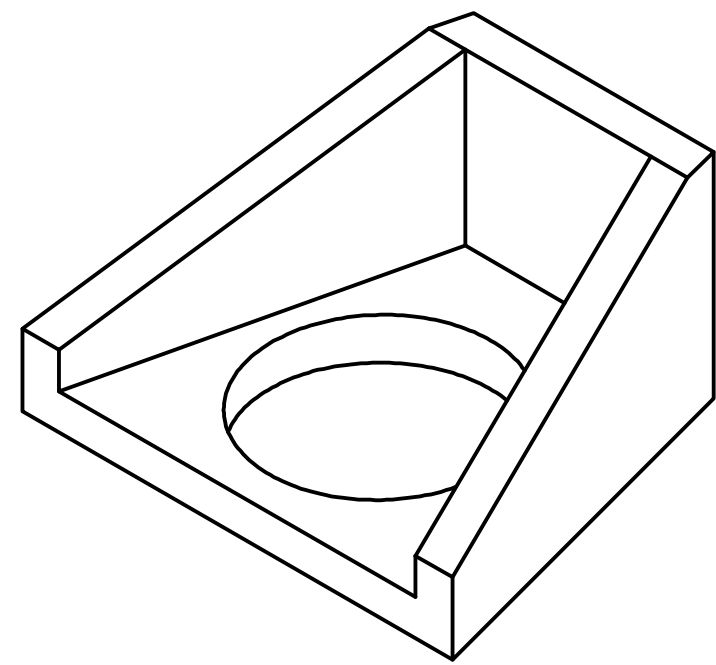

3D VIEW (1:15)

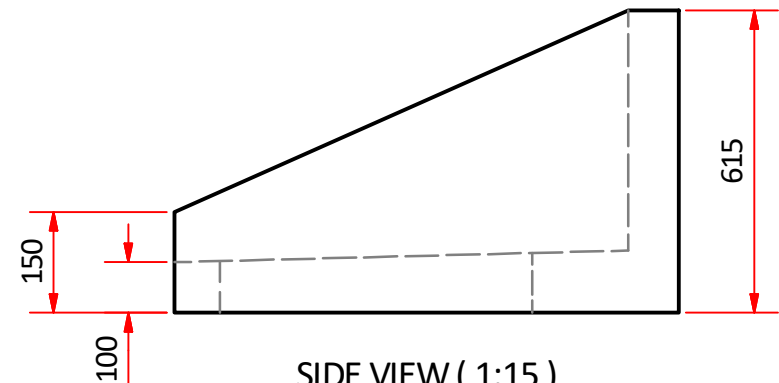

SIDE VIEW (1:15)

- General Notes;
- 1. All dimensions are in mm
 - 2. Tolerance on all dimensions ± 3 mm unless stated otherwise

Copyright: TRI Underground Australia Pty Ltd

This instruction and all the information herein is the property of TRI Underground PTY LTD. It must not be copied, made public or used directly or indirectly, including manufacture of the product shown herein, without written approval. This instruction is loaned subject to these conditions and subject to return on demand.

Commercial in confidence

	Material CONCRETE	Designed by IMD	Checked by HL	Approved by HA	Date 23/03/2022	Date 22/01/2022		
	Weight APPROX. 500 kg	TRI Underground Australia			Title CONCRETE BASE PLATE MOUNTED POLE			
	Finish OFF MOULD				Dwg No. 13755		Edition A	Sheet 1 / 1